



The story of Prestbury School

The First School

There is no Free School or Hospital in this Parish. But some Gentlemen taking into their Pious and Charitable consideration the gross ignorance and miserable condition of the Poorer sort for want of Education about two years since set up a school by their own Private Contributions

*for instructing all the Poor Children of the
Poor of the Parish in Religious Reading
Writing and Accounts which by the blessing
of God they happily carry on and do design to
put them all put Apprenticed as fast as they
become fit.*

Terrier of Church Lands Attwood Papers D177 - Gloucestershire Archives

Founded at 'All Hallows tide' 1702

Rev Francis Welles

Justice of the Peace (from 1714) for over 50 years.

Vicar of Prestbury
1694 - 1756

“Most laborious
and painstaking of
Justices”

“Stern disciplinarian
and upholder of
female decency and
decorum”



The Charity School Movement

Charity-Schools <i>In the Counties, Towns, and Pa- rishes following.</i>	No. of Sch.	BOYS.	GIRLS.
GLOUCESTER CI.—	1	50	20
Huntley—	1	10	
* Kempley—	1	12	
Laberton—	1	20	
Leonard Stanley—	1		
Mashfield —	1	12	
Michell Dean —	1	25	
Mincing Hampton	1	9	
Newent—	1	20	
Oxenhall—	2	20	
Painfwick —	1	11	
Prestbury 1702	1		
Puckle-Church —	1		
Randwick —	1	8	

Prestbury 1702

A directory of Charity Schools 1717

THE METHODS

Used for ERECTING

Charity-Schools,

WITH THE

RULES and ORDERS

By which they are Governed.

A particular Account of the

LONDON CHARITY-SCHOOLS:

WITH

A LIST of those Erected elsewhere

IN

Great Britain & Ireland.

To which is added,

A Particular Account of such SCHOOLS as
are Reported since last Year to be set up.

A N D

An APPENDIX, containing Forms, &c. relating to
the CHARITY-SCHOOLS.

The Fourteenth Edition, with Additions.

L O N D O N,

Printed and Sold by Joseph Downing in Bartholomew-Close
near West-Smithfield, 1715.

New Records

Heavily influenced by the work of the SPCK and the Charity School movement.

- Provides details of school life, structure & curriculum
- Prestbury School is listed
- Form of words used in records

School Masters

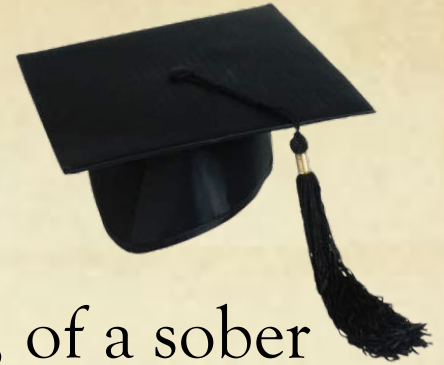

- Be a member of the Church of England, of a sober life and conversation and not under the age of 23.
- A person of known affection to his present majesty King George and to the Protestant succession
- Understand well the grounds and principals of the Christian religion.
- Have a genius for teaching, write good hand and understand arithmetick.

Curriculum



Youth is the seed-time of life ; let me then entreat you, now, whilst you are young, to avail yourselves, with the utmost assiduity, of the advantages which are offered to you ; be diligent, obedient, teachable, now, that hereafter you may become good Sisters, good Daughters, good Wives, and good Mothers ;

Apprenticeships

Prestbury, Gloucestershire. A Sch. for teaching all the poor
Ch. 7 Apprentices have been put out to Trades, but the general-
ty of the Ch. go off to *Husbandry* and Country Business, being
much sooner fitted to get something towards a Livelihood in that
Way.

Those taking on apprentices in Prestbury 1710-1811:

William Clarke (Carpenter)
Robert Cook (Baker)
Samuel Davis (Carpenter)
John Davis (Carpenter)
John Fisher (Cordwainer)
Richard Fisher (Cordwainer)
William Freeman (Cordwainer)
John Hall (Baker)

Theophilus Holland (Butcher)
Thomas Newton (Taylor)
Robert Potts (Tanner)
John Reeve (Carpenter)
Samuel Trapp (Cordwainer)
Henry Wheeler (Blacksmith)
George Wilkinson (Butcher)

Religious Instruction

- The make their chief business to instruct the children in the principles of the Christian religion (C of E)
- That their minds be not tinctured with any new and singular notions, either in religion or government; and that they be **restrained diligently from unnecessary speculation of all kinds**, and confined to such doctrines and principals as more immediately concern faith and a good life.



The School Day

- Pray morning and evening at the school and teach children to do the same at home and also to say grace before and after meat.
- Children's names be called over every morning and afternoon; and if any be missing, to be put down with notes for Tardy or Absent.
- School hours to be 7-11am, 1-5pm in the *summer* and 8-11am, 1-4pm in the *winter* with breaks for the *three great festivals*.





School Rules

Take particular care of the manners and behaviour of poor children; and by all proper methods discourage and correct the beginnings of vice; such as:

- Great faults to be noted as **Lying, Swearing, Stealing, Truanting, Playing at Church** etc... and they be noted down in monthly or weekly bills to be laid before the subscribers and trustees.
- Not to be seen with any mob, those who play dice or unlawful games in the street, not to go about begging money for bonfires.

School Uniform



School uniform is thought to have been introduced by London charity schools.

Servants also started to wear uniform at this time and we see the de-personalising of the working class.

Partly in response to concerns that pupils may become “too educated” for their station in life.

To identify them as someone in receipt of charity.

Example School Uniform

An ACCOUNT of the RATES of Cloathing Poor Children belonging to CHARITY-SCHOOLS.

The Charge of Cloathing a BOY.

	<i>l.</i>	<i>s.</i>	<i>d.</i>
A Yard and half-quarter of Grey <i>Yorkshire</i> Broad Cloth, 6 quarters wide, makes a Coat ————	00	03	05
Making the Coat, with Pewter Buttons, and all other Materials ————	00	01	00
A Waistcoat of the same Cloth lined ————	00	03	10
A pair of Breeches of Cloth or Leather lined ————	00	02	09
1 Knit Cap, with Tuft and String, of any Colour ————	00	00	10
1 Band ————	00	00	02
1 Shirt ————	00	01	06
1 Pair of Woollen Stockings ————	00	00	09
1 Pair of Shoes ————	00	02	00
1 Pair of Buckles ————	00	00	01
1 Pair of Knit or Wash-Leather Gloves ————	00	00	07
The Total	00	16	11

Prestbury Uniform



The Charge of Cloathing a Girl

Gown and petticoat of Blue Ells	4s. 8d.
Shift	1s. 0d.
Chequered apron	1s. 0d.
Woollen stockings	8d.
Shoes	1s. 8d.

Other references

- A building is mentioned in 1712
- “Singing was taught to some good effect”
- “Young people have come into it with uncommon delight, and form their parts so well in public worship”
- “A gallery was built for the purpose” – 1729 SPCK report



1702? 1712 1729

Other references

My design in this, and in all my plans for your instruction, is, to make you “wise unto salvation;” and, as Poetry is more easily recollected than Prose, I wish to impress upon your minds, such as will tend to improve your hearts, and strengthen your good principles.



S.P.C.K. Archives



- Francis Welles gave an annual donation of £2.2s to the S.P.C.K.
- The last official report to the S.P.C.K. about the Prestbury School was in 1729 however...
- The Rev Francis Welles died in 1756 and left a legacy of £10 to the S.P.C.K.
- SPCK records show number of charity schools in the county remain the same until about 1765.

1702? 1712 1729 1756 1765?

What happened next?

- The 1826 Charity Commission report does not mention there being a charity school in Prestbury.
- Children from Prestbury may have attended other schools in neighboring parishes. (e.g. 1830 Rebecca Lightbourne School, Whittington)
- Mrs Williams of Prestbury founded the Girl's School of Industry in Cheltenham but the model of education didn't really work.



Prestbury National School



The National Society

- The National Society was founded in 1811 as the "National Society for Promoting the Education of the Poor in the Principles of the Established Church in England and Wales".
- Their schools were known as National Schools.
- Its aim was that *"the National Religion should be made the foundation of National Education, and should be the first and chief thing taught to the poor..."*

Randall's Orchard



- Land given by Thomas Edwards of the priory for the erection of a school around 1826

“To be at all times used occupied and enjoyed as and for a school for the education of poor children both male and female, of the Parish of Prestbury aforesaid in the principals of the Protestant Church of England and Ireland as by law established and in union with the incorporated National Society and not for a school of any other kind and not for any other purpose whatsoever.”

1702? 1712 1729 1756 1765?

1826

The new school

NATIONAL SCHOOL IN PRESTBURY.

AT this place, a National School, sufficiently capacious for the reception of fifty boys and fifty girls, is about to be built, and to be supported by subscription. T. Edwards, Esq. and the Rev. J. Edwards, Incumbent of **Prestbury**, have offered a piece of ground for the purpose; and these gentlemen, in conjunction with Major Baines, the Rev. C. Capel, Messrs. Smith, Whalley, and J. Nicholson, constitute a committee for the purpose of effecting the benevolent and desirable object.

- 1834 Churchman's Miscellany report
- Gates "est. 1835"



1840s

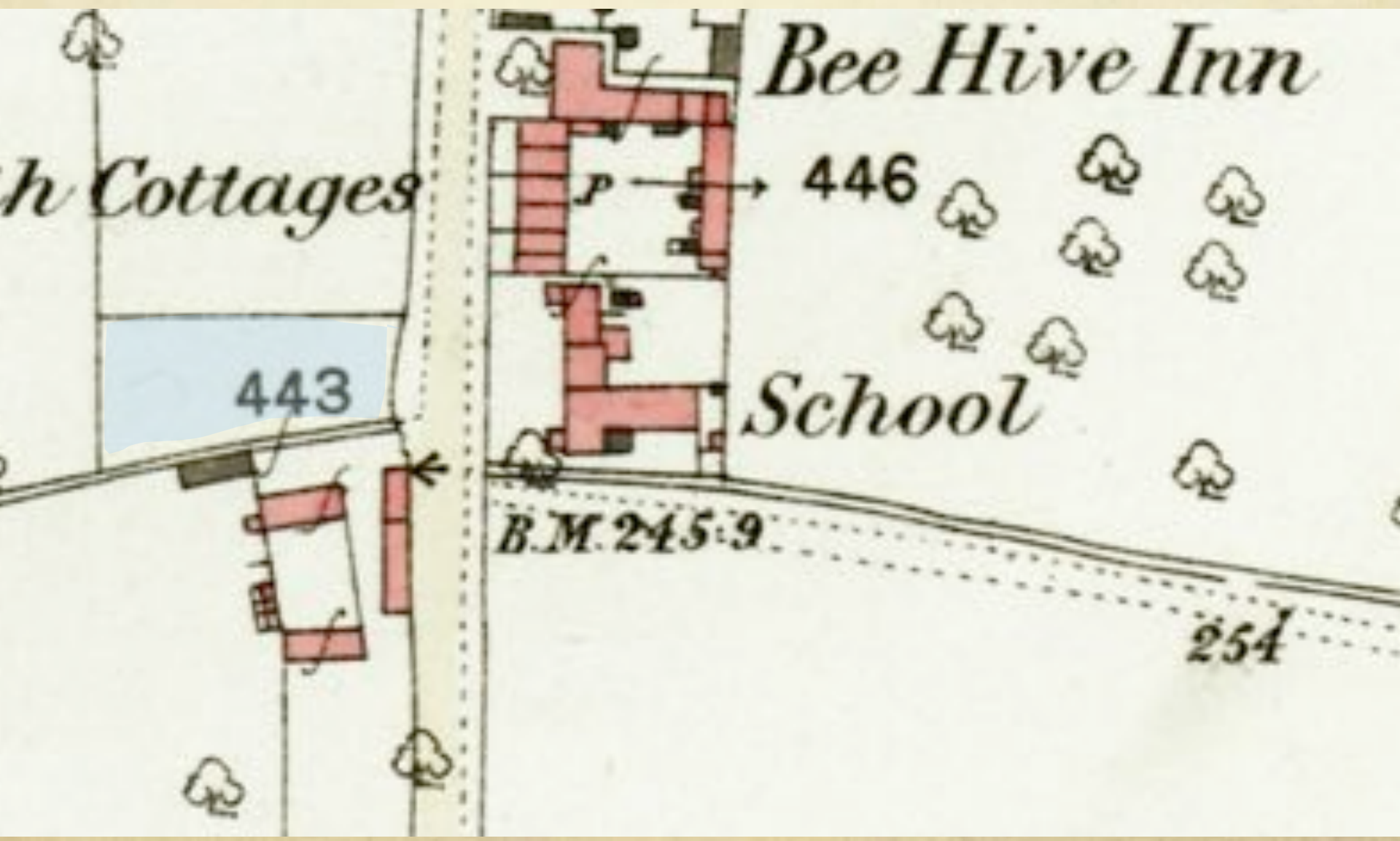

Central Schoolhouse

Classrooms either side



Early Teachers



PRESTBURY NATIONAL SCHOOL.
WANTED, a MAN and his WIFE, of middle age, or under, capable of taking the charge of the above SCHOOL. There is a comfortable RESIDENCE and Garden attached to the School.—Apply to the Rkv. J. EDWARDS.

*1836 ad in
Cheltenham
Chronicle*

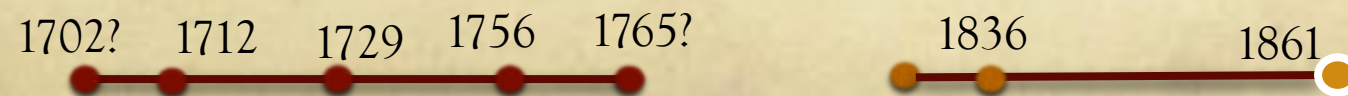

Early Teachers



- Thomas Gardener and Ann & William (6mo) 1841
- George Monk and Mary 1851
- Edward Thomas and Mary, Edward pupil teacher and Mary teacher (age 17, 12) 1861

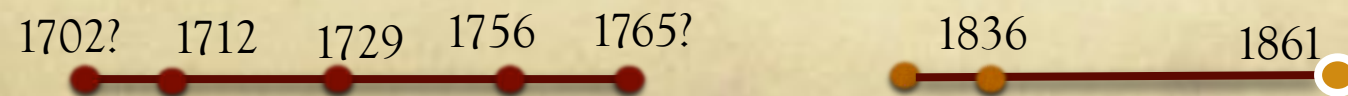

"In very low condition"

- Limited resources and teachers
- Pupils had to walk form miles around
- Children had to pay to attend. 1p or 3p a week
- Only heating was a fire
- No gas light until 1868



"In very low condition..."

Inspector's Report 1863

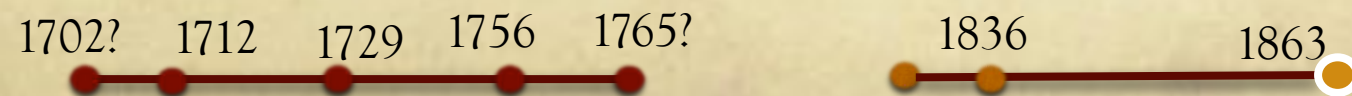

Edwin Bradfield



- Schoolmaster for 25 years
- Very young when started around age 20
- Assisted by sister Ellen and a pupil teacher
- Wife Emma (nee Mayall)

“...will look for a better report on your school next year”

1864 report

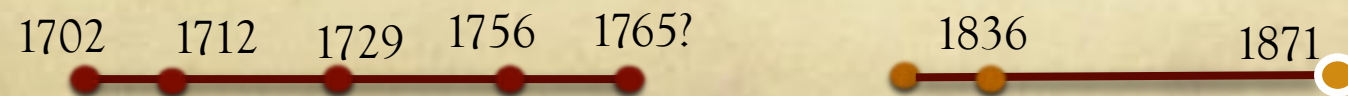

Edwin Bradfield



- 1881 Emily age 16 'Monitoress'
- Also a rates collector, secretary of the C of E Working Men's Society, Prestbury Oddfellows and clerk to the Parish Council.
- Made a speech in support of the Rev De la Bere during controversy.
- Died 1915 at Creswell House

"Secular persecution"

"Unjustly afflicted"

"Almost superhuman"

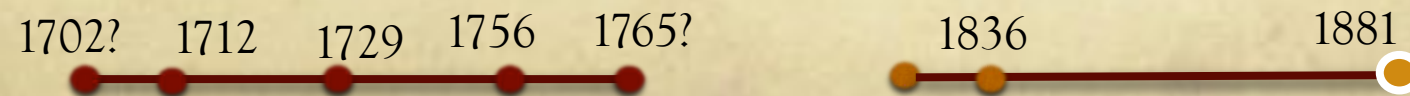

School Log Books



Victorian School Day

9:00	Writing
9:30	Register
9:35	Scripture
10:15	Dictation
11:15	Geography

Lunch

1:30	Reading (or History)
	<i>Girls go to sewing</i>
2:15	Spelling
2:40	Arithmetic
	<i>Girls rejoin class</i>
3:30	Catechism & Hymns

187

Time Table. Sept. 1869.

A. M.	Classes.		
Time	1	2.	3.
9--9.30	Writing	Writing	Reading.
9.30-9.35	Registers.		
9.35-10.15	Scripture (Old. Test. History.)	Scripture	Scripture (First Catechism)
10.15-10.40	Dictation & Reading (Jesus H. Geo. H. & F. Reading Hk.)	Reading	Writing (Spelling written on 13 sound)
10.40-11.15	Reading	Dictation	Spelling (Words faintly written)
11.15-12	Arithmetic.		
	1 st Class	Geography on Wednesdays	
P. M.	1	2	3
1.30-2.15	Reading (New. Test. History)	Reading	Reading.
	Girls sewing at 2. Registers &c.		
2.15-2.40	Spelling & Dictation		Spelling.
2.40-3.30	Arithmetic		Arithmetic
3.30-4	Catechism		Catechism
	Girls return from sewing class at 3.30.		
Sept. 17	The Year ended the school in the Afternoon & heard the children sing through the Hymns for Holy Communion. Progress made during the week entirely satisfactory, but the hands thin		

Needlework



To know how to seam, hem, sew on strings, button hole, sew on buttons, stitch, mend stockings, plain darning. Cut and make a pinafore.

No unnecessary talking to go on during the lesson. Any girl wanting anything to stand up until waited upon.

“1 or 2 boys proving dexterous at the work”

“Infant boys have made a good start with knitting”



Attendance

- Bad weather, reaping, wheeling coal, child-minding, potatoes
- Boot fund set up for poor children. Some allowed for free.
- Holding horses for the cavalry ‘intense joy’ or the races. Launch of Cheltenham lifeboat.
- Attendance Officer 1870, 1880 compulsory age 5-10, 1890 82%

“On account of the school treat”



ILLNESS & Epidemics

- Epidemics of whooping cough, measles, mumps, flu, brain fever smallpox, croup etc...
- Some pupils died, usually from 'fever'
- Boys room often kept without a fire due to "*unpleasant closeness*"
- Collections often made for the mothers of any children who died.



Extra Curricular

- Christmas treat with prizes, recitals, singing and “*several presents*”. Parents invited and children given oranges, apples and buns.
- How to write a letter and use an envelope
- Scratching letters on a slate with a nail
- Trips over the hills on a fine day
- Hired a **magic lantern** from Cheltenham
- Oct 1863 “shock of an **earthquake** felt in the village”

Hymns to learn, frequently attended church, vicar gave assembly.



Equipment

- Sewing machine
- Electric gramophone
- Piano/harmonium
- Cricket bats
- Swing



“A place convenient for both boys and girls to use”



John Rylands

- Sister Emily (35 years mistress of infant school)
- Wife Eliza also a teacher.
- Mother Mary Ann retired housekeeper, widow.
- Son Frederick (age 23 at Oriel College Oxford)
- 1891 – 1911 census

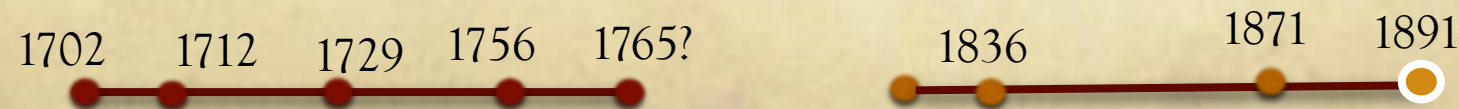

1890s

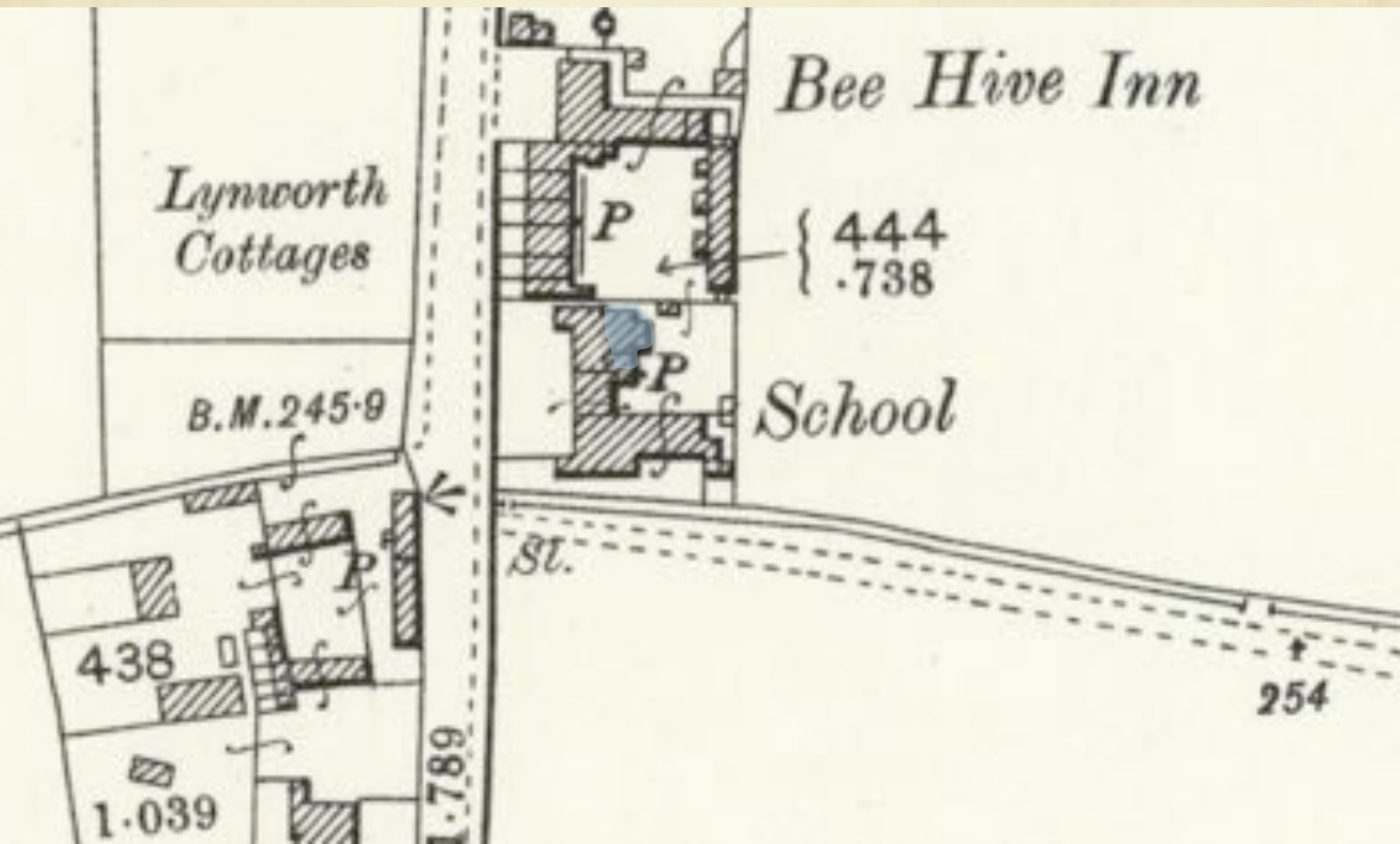

The Blue Box



Expenses, salaries, appointment of teachers, maintenance, cleaners, caretakers, correspondence, contracts for supplying coal, school reports, plans.

1702? 1712 1729 1756 1765?

1836 1871 1902

The Managers

Alfred Wiggett, John Coates Carter, Sir James Seabrooke, Rev De la Bere, Richard Bagnall Oakley...



1702? 1712 1729 1756 1765?

1836 1871 1902

The Edwardian Era



PRESTBURY VILLAGE ENTERTAINMENT.

The annual Village Entertainment organised by Mrs. Baghot De la Bere, assisted by Miss Baghot De la Bere, took place at Prestbury Schools on Tuesday and Wednesday, December 30th and 31st.—The performers.—Photo by Cheltenham Newspaper Co., Ltd.

Education act 1902

Change of name to
Prestbury Church of
England School 1906

Provide cocoa for the
children, gas stove.

1912 school play

World War One



- Frederick went off to fight (1918/19 ER)
- Served with a lighting order to put up blackouts
- Aircraft insurance was added the year before
- The price of coal went up
- Women added to the sub committee
- Land sale held up 'service abroad'



1920s

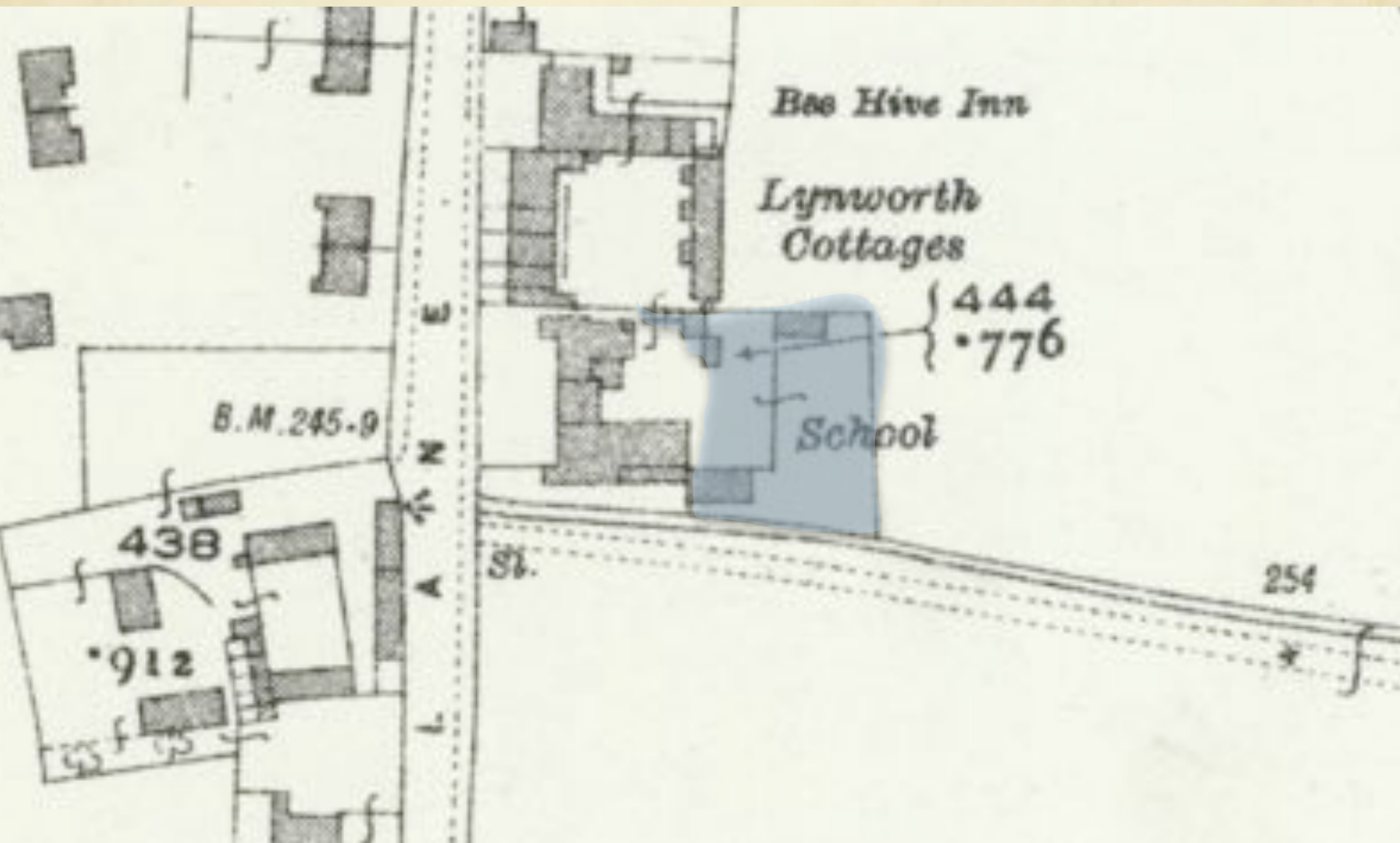

Mr Armstrong

- He was 6 on the list of candidates to be interviewed but impressed the managers in 1922 .
- A bad inspection report in 1927 lead to a letter of concern being sent and demanded he appear before the managers.
- Issues with accuracy of log books, condition of the school and garden, manners of pupils, attendance, his use of corporal punishment.

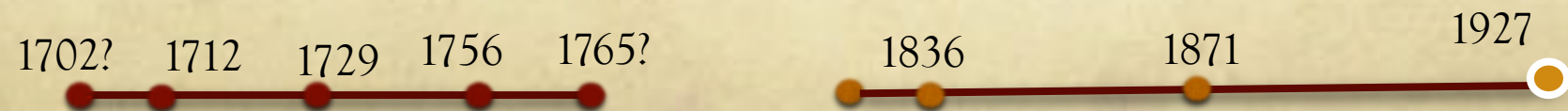

Mr Armstrong

- 4 children qualified for senior school. “Mr Armstrong to be congratulated”
- 1930 school report
- 1937 remodeling the school scaled down due to expense.
- Retired in 1950



Miss Davies



HONOUR FOR PRESTBURY SCHOOL

In a sewing competition open to all schools in England, and in which over a thousand schools competed, Evelyn Taylor (13), of Prestbury School, won the All-England Cup and £2 presented by Messrs. Horrocks, Crendson, and Co., Ltd. Twenty-five other girls in the school received money prizes and certificates for their good work. Evelyn Taylor is seated in centre of middle row, holding a replica of cup. Miss Davies, the headmistress (inset), was presented with a framed painting by her pupils.

[*Cheltenham Chronicle* Photograph. Copies 1s. and 1s. 6d.]



1937 - central heating



School Extension 1938



Wartime 1940s

- School garden to be used to grow produce. Basil Newman to help to grow vegetables.
- Wartime exception to employ two teachers who were not C of E
- Milk judged unfit by ministry of food and sent to be analysed



Evacuees in Prestbury

- Evacuation and air raid precautions
“now over 180 pupils due to evacuees”.
- Evacuees being forwarded to the parish school
- 20 pupils attended in the holidays



Christmas Party 1940



CHRISTMAS PARTY TO PRESTBURY CHILDREN

A delightful Christmas party was given on Saturday at the the Women's Institute to children of members and evacuated children.

- 1.—Miss L. Ratcliff distributing presents from the Christmas tree to the children. 2.—Mrs. G. Readings presenting first prize to Michael Williams (a magician) in the fancy dress parade.

"Cheltenham Chronicle" Photographs. Copies 6½ ins. x 4½ ins. 1/-, 8½ ins. x 6½ ins. 1/9. Postage 3d.

Fire Watchers

- Black out lower hall for local fire watchers and ARP to watch for fire-bombs.
- “unnecessary to give up a room when caretaker is sleeping on premises”
- “Not advisable for young men and women to spend the night there together...”
- No change to current situation but perhaps consider an electric fire.



School Dinners

Provided by the
WVS using a
mobile kitchen
presented by the
people of New
South Wales,
Australia in 1942
for 4d a head.



HELPING HANDS

Children at Prestbury School fetching their plates from the large mobile kitchen, presented by people in New South Wales, Australia, to help in blitzed areas. It is being used by the W.V.S. in Cheltenham Rural Area to supply hot dinners at 4d. a head to village schoolchildren.

"Cheltenham Chronicle" Photograph. Copies 1/6 and 2/3.

Challenging times

- Overcrowding is a “serious problem” pupils sent home
- To become an ‘aided’ school
- Caretaker’s house become a classroom when she leaves
- “Uncertain future of the school”
- Temporary hut to be erected using bequest from Jessie Edwards.
- Application for a dining hall, use of WI hall and church house for additional teaching space.
- 1949 report

1940s

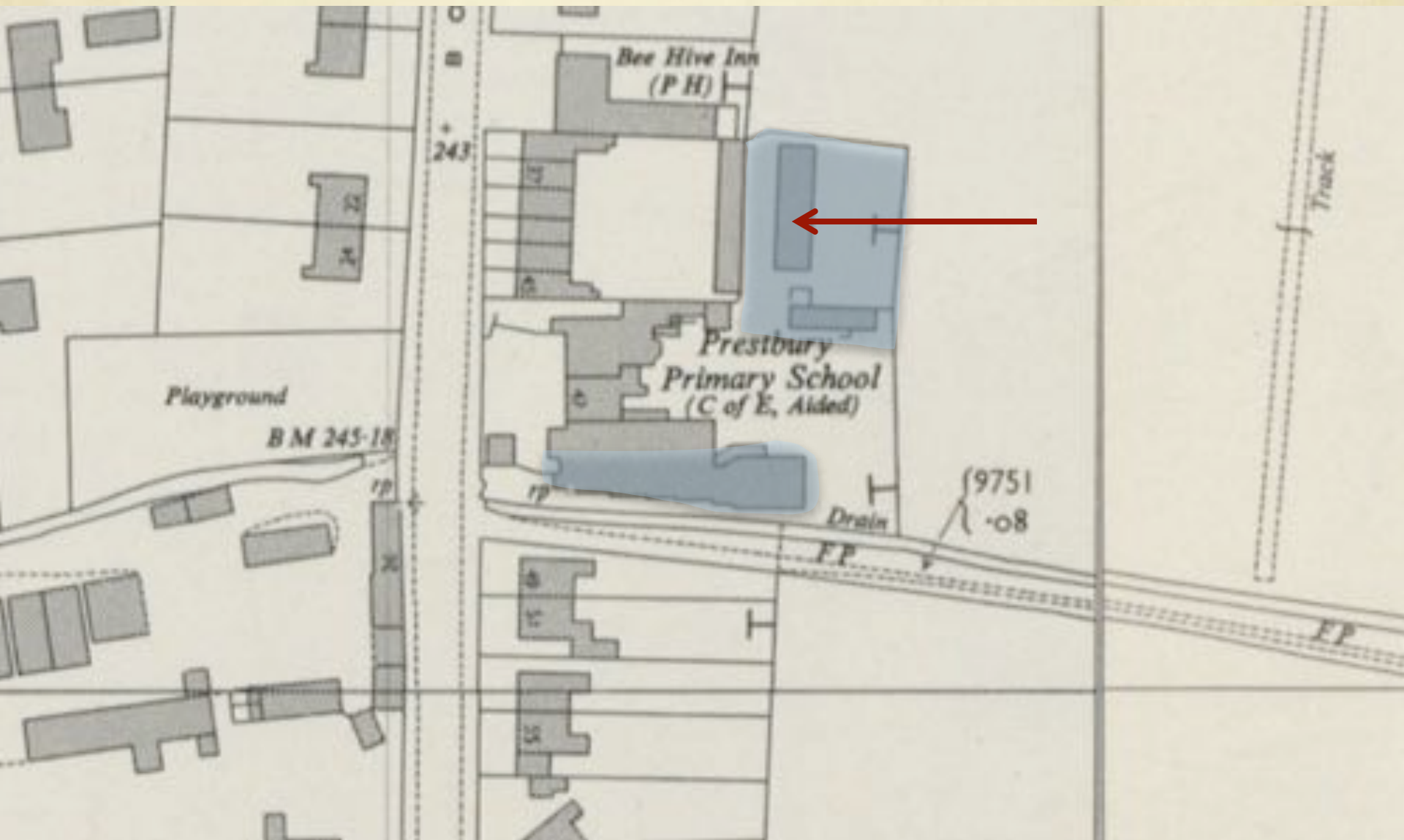

Temporary Hut



Mr Thake

Growing pupil population and overcrowding

1836 = 100 1940 = 180 1952 = 331 1960 = 274

Lynworth and Whaddon schools

New Classrooms added (1959 plans)

Additional playground area

Use of the new church hall for school dinners

1952 school report



1950s New Classrooms

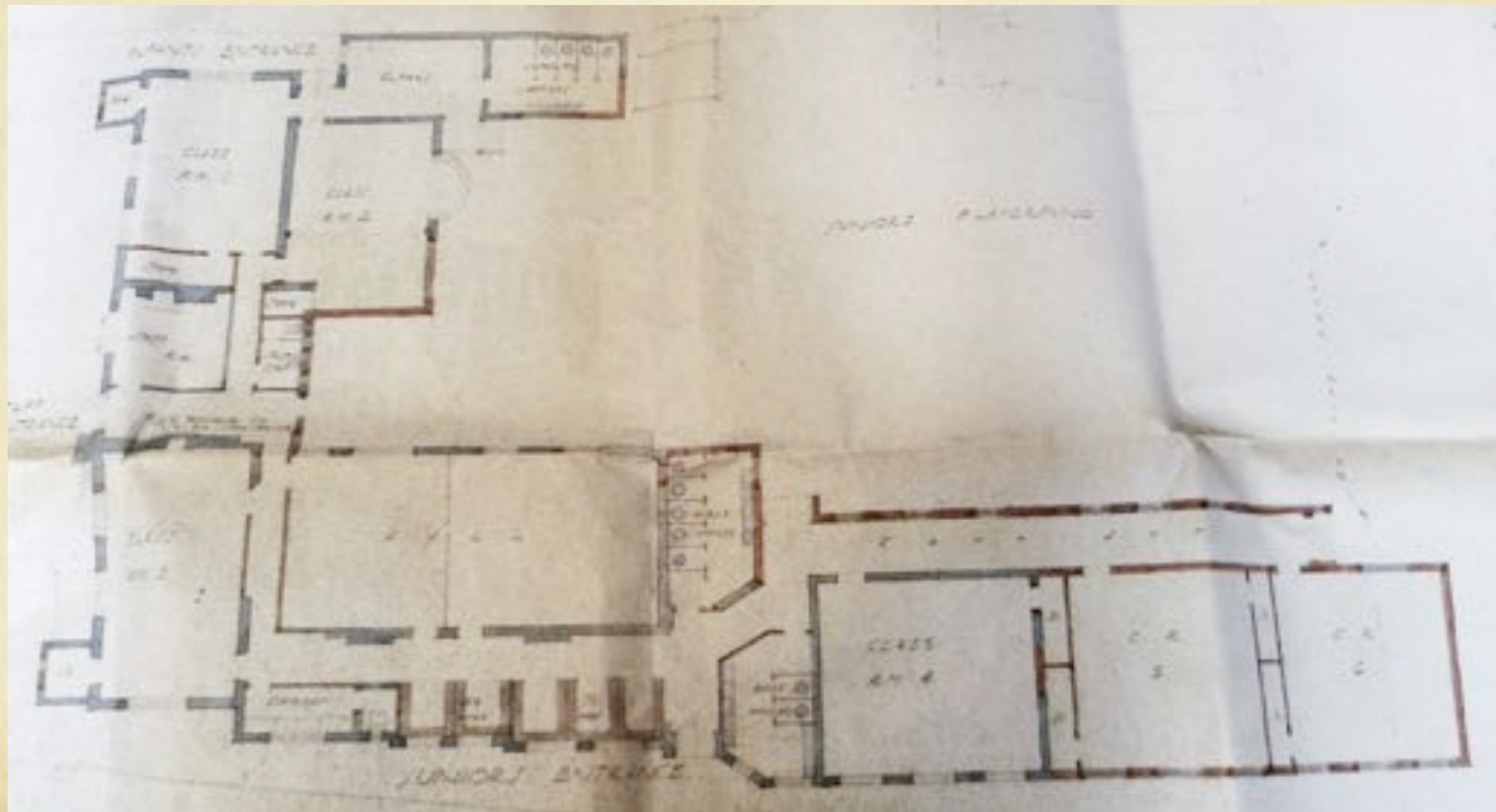

1950s Playground



1950s 'Dinner Hall'

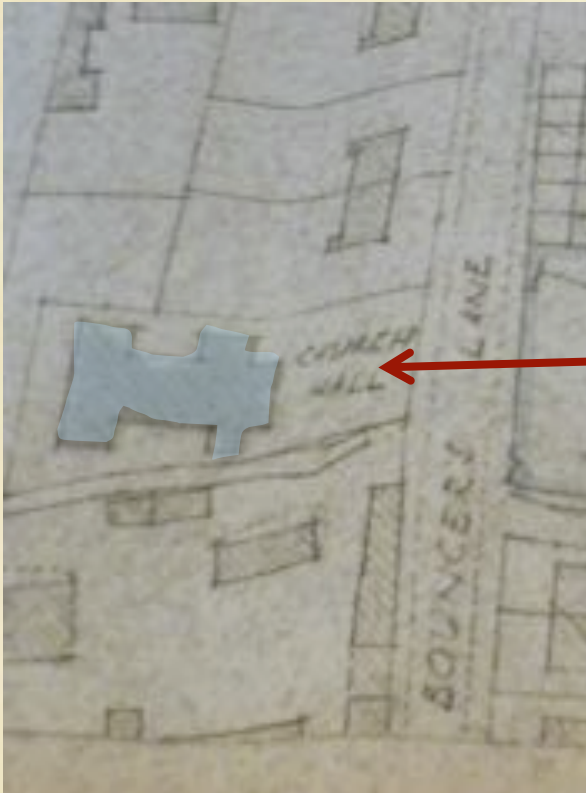

1960s - Infant School

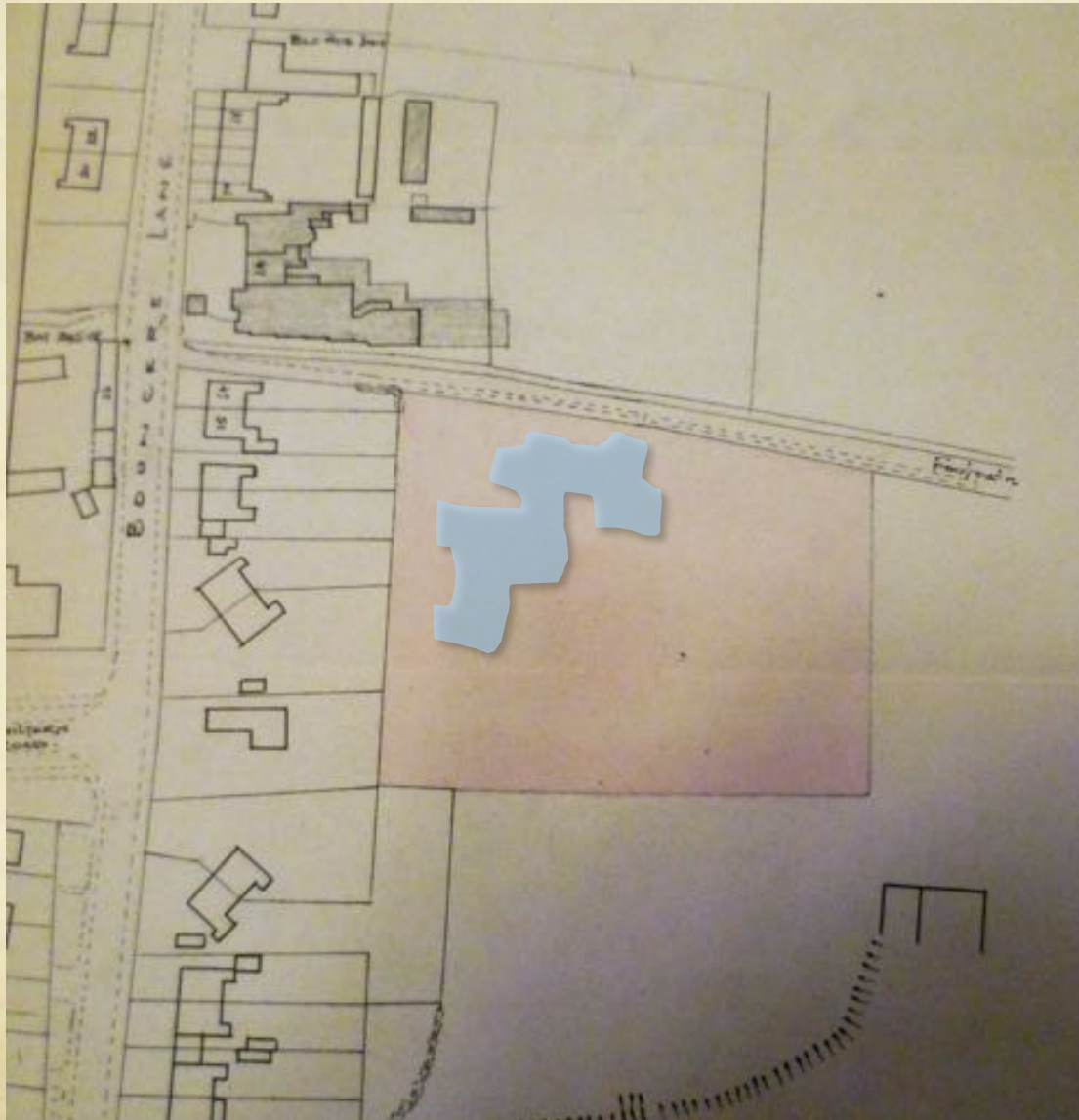

Former gravel pits



St Mary's in 2017



Your memories...

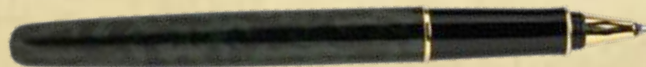

SNOW in 1982



Photos by Edward Wyatt



1950s Memories

- In the fifties the Infants School entrance was that nearest the terrace of cottages. The front classroom was the Infants headmistress, the well loved **Miss Fieldhouse**.
- Behind that was another classroom, **Miss D'Amato**. The entrants class room was a nissen hut behind the terrace. East side of the hut, the school garden and lawn. Juniors entered by the entrance The Pieces side.
- Headmaster **Mr Whybrow** and then **Mr Outhwaite**.
- The juniors first room was half of the school hall with a dividing screen. The school was also used on Sundays by St Mary's Sunday school , superintendent **Miss Winnington Ingram**, sometime Vice Principal Ladies' College.

Remembered by Roger Beacham

1930's class



Given by Mr Newman

1910 class



Given by Mr Newman

Visit to Cheltenham fire station 1949



Given by Mr Newman

1890s class



Given by Mr Pockett

Prestbury Choir Boys



Given by Mr Julier

2 - Mrs Christine Vooght.



Given by Neil Pryce-Jones

